

LEGEND

- 1** Sports Building
- 2** Sports Arena
- 3** Synthetic Hockey Pitch (non-water based)
- 4** Athletics Track (400m)
- 5** External Synthetic Multi-Sport Pitch
- 6** Sand Mattress GAA Fields
- 7** Covered Stands (3No.)
- 8** Toilet Block
- 9** Cricket Practice Nets

- SITE BOUNDARY
- NATURAL TURF PITCH SURFACE
- SYNTHETIC GRASS PITCH SURFACE
- ATHLETICS TRACK - EPDM POLYMERIC RUBBER SURFACE
- GRASS SURFACE / SOFT LANDSCAPED AREAS (Refer to Landscape Architects Drawings ref: CSC-MLA-XX-0-DR-L-2001)
- EXISTING NATURAL LANDSCAPE AND HABITAT MAINTAINED
- WILDLIFE HABITAT CREATION ZONE (Refer to Landscape Architects Drawings ref: CSC-MLA-XX-0-DR-L-2001)
- PEDESTRIAN PAVEMENT - ASPHALT / BITMAC
- PEDESTRIAN PAVEMENT - NATURAL GRANITE AGGREGATE CONCRETE PAVING SLABS
- VEHICULAR PAVEMENT - ACCESS ROAD / PARKING
- EXISTING DENSE HEDGEROW VEGETATION
- EXISTING TREE
- PROPRIETARY CONCRETE BLOCK GEOSYNTHETIC REINFORCED SEGMENTAL RETAINING WALL SYSTEM (Refer to drawings CSC-MCA-01-XX-DR-A-8001 & 2)
- TIMBER CRIBB RETAINING WALL STRUCTURE (Refer to drawings CSC-MCA-01-XX-DR-A-8001 & 2)
- 1.2M HIGH BALL CATCH NET (Refer Detail B on Dwg A2156-800-02)
- 1.2M HIGH OPEN MESH FENCING (Refer Detail E on Dwg A2156-800-03)
- 3.0M HIGH OPEN MESH FENCING (Refer Detail G on Dwg A2156-800-03)
- 4.2M HIGH OPEN MESH FENCING (Refer Detail G on Dwg A2156-800-03)
- 1.1M HIGH GALVANISED STEEL SAFETY RAILINGS (Refer Detail F on Dwg A2156-800-03)
- 1.2M HIGH TIMBER POST & RAIL FENCE (Refer Detail H on Dwg A2156-800-03)
- 2M HIGH TIMBER ACOUSTIC FENCE (Refer Detail C on Dwg A2156-800-03)
- 600MM HIGH TIMBER KNEE RAIL FENCE (Refer Detail D on Dwg A2156-800-03)
- PROPOSED ACCESSIBLE SHARED PEDESTRIAN AND CYCLE ROUTE LINKING DUBLIN ROAD AND KILNAVARRAGH LANE - Max Gradient < 1:21
- PROPOSED LOCATION OF FLOODLIGHT COLUMN (Refer Detail L on Dwg A2156-800-03)
- PROPOSED BOLLARD PATHWAY LIGHT (Refer Detail J on Dwg A2156-800-03)
- PROPOSED LIGHTING COLUMN - SINGLE LUMINAIRE (Refer Detail K on Dwg A2156-800-03)
- PROPOSED LIGHTING COLUMN - DOUBLE LUMINAIRE (Refer Detail K on Dwg A2156-800-03)
- ELECTRIC VEHICLE (EV) CHARGE POINT
- PROPOSED DUCTING PROVIDED FOR FUTURE EV CHARGING POINT
- PROPOSED FIXED BOLLARD - STAINLESS STEEL WITH VISIBILITY BAND. REFER TO LANDSCAPE MATERIALITY SHEET CSC-MLA-XX-0-DR-L-3001
- PROPOSED REMOVABLE BOLLARD - STAINLESS STEEL WITH VISIBILITY BAND. REFER TO LANDSCAPE MATERIALITY SHEET CSC-MLA-XX-0-DR-L-3001
- PROPOSED LITTER BIN. REFER TO LANDSCAPE MATERIALITY SHEET CSC-MLA-XX-0-DR-L-3001
- PROPOSED EV CHARGING PARKING SPACE
- PROPOSED ACCESSIBLE PARKING SPACE
- PROPOSED LEVELS

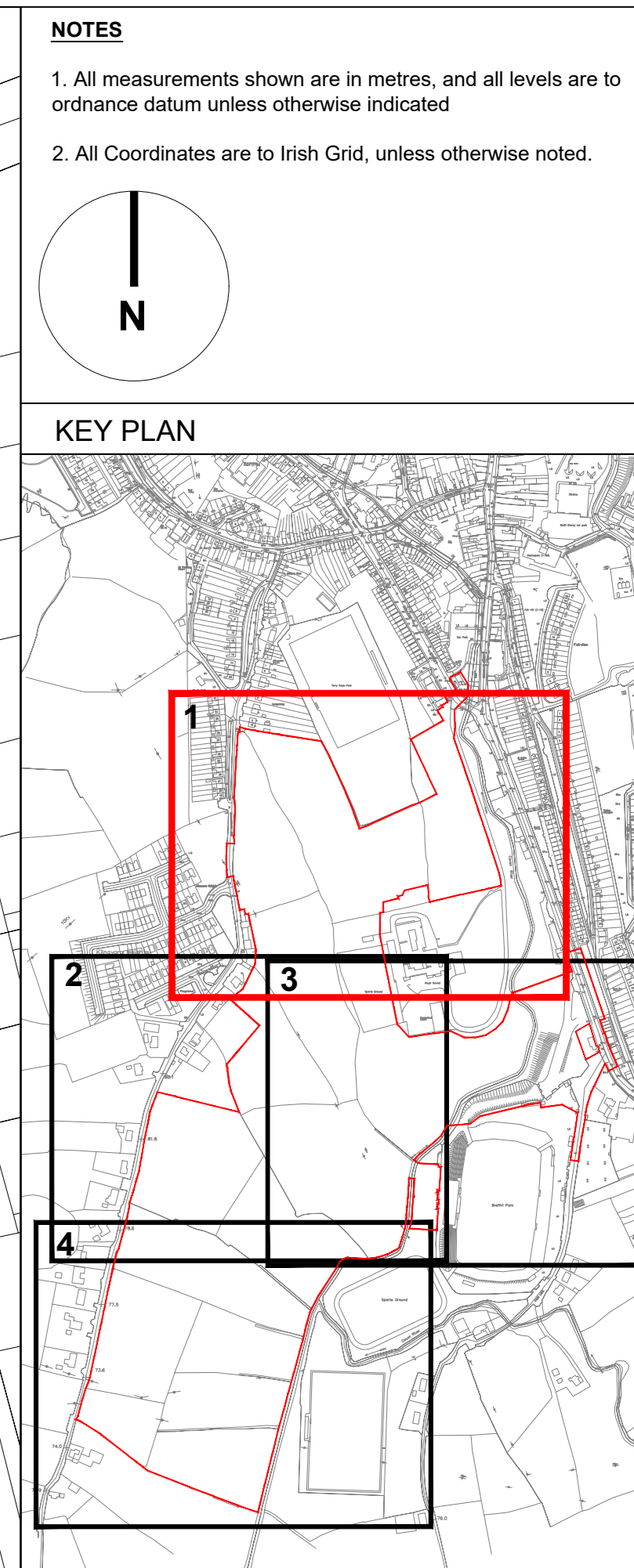
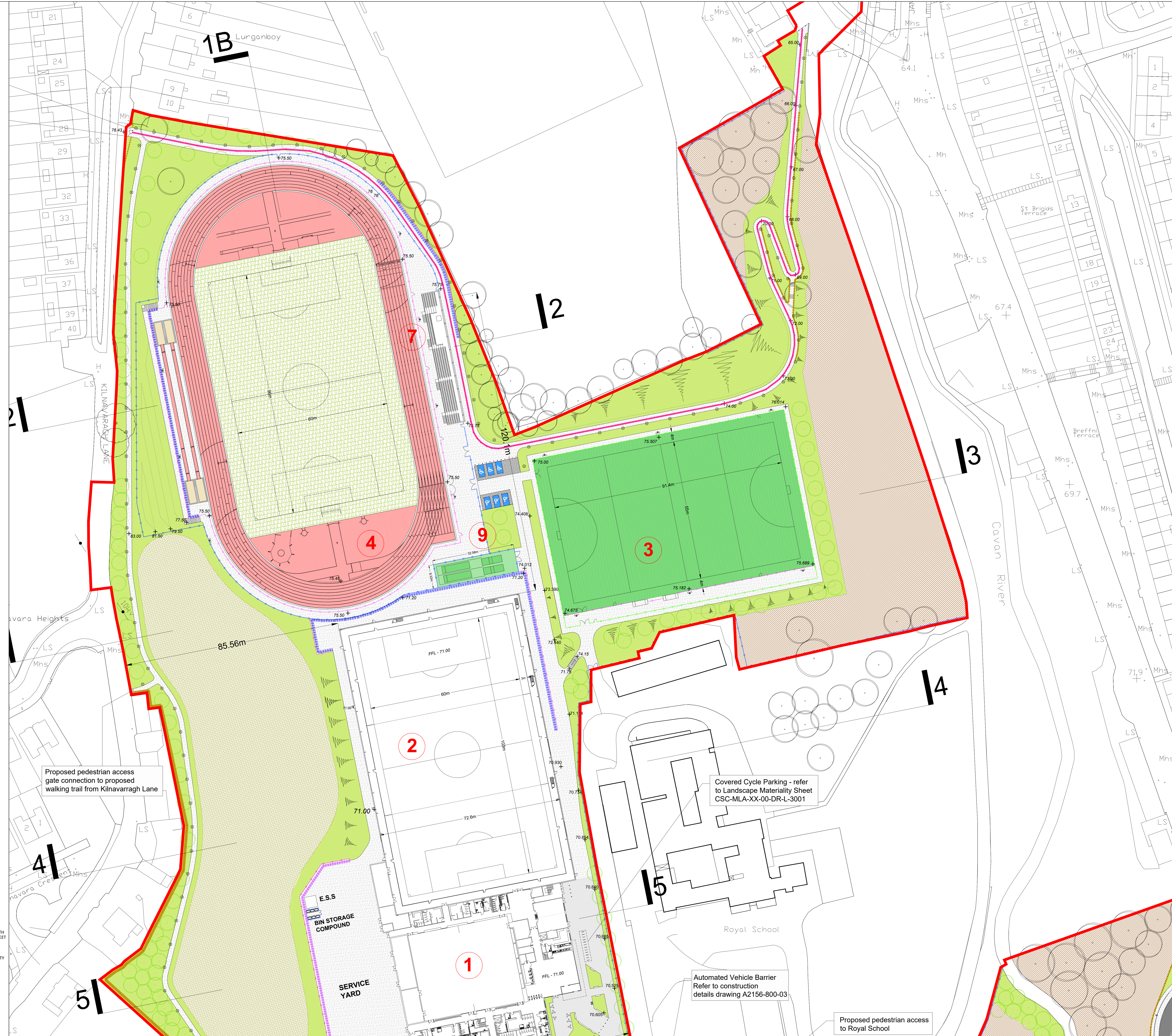

NOTES

1. All measurements shown are in metres, and all levels are to ordnance datum unless otherwise indicated
2. All Coordinates are to Irish Grid, unless otherwise noted.

Rev	Issue Date	Description	App

Status: **PLANNING**
 Client: **Cavan County Council**
 Project: **Cavan Regional Sports Campus**
 Drawing: **Proposed Site Plan - Sheet 1 of 4**
 Scale: **1:500 @ A0**

McAdam
 ENHANCING LOCAL COMMUNITIES

Contact Details: To Montgomery House, 478 Castlewegh Road, Belfast, BT5 6BQ. T: 028 9040 2000. E: adam@mcadamdesign.co.uk, www.mcadamdesign.co.uk

Drawn	Checked	Approved
moc	pa	moc
Date: 18/02/24	Date: 18/02/24	Date: 18/02/24

Project Number: **A2156** | Drawing Number: **100-11** | Revision:

All dimensions are in metres. Figure dimensions to be taken in preference to scale dimensions. Dimensions to be checked on site. © 2021 McAdam Design Ltd.