

General Notes:

- This drawing is to be read in conjunction with all relevant Architects and Structural Engineers Construction issued drawings, Fire Certificate and Fire Drawings, along with the consultants Mechanical and Electrical specifications and any other documentation.
- Do not scale from this drawings. This drawings is representative only. All dimensions are in millimeters (mm), unless otherwise stated. Use the figured dimensions when shown.
- The exact location of all services and fittings to be agreed on site with the Architect and/or Structural Engineer prior to their installation.
- The Mechanical and Electrical Services are to be coordinated with all other trades and to be agreed on site prior to their installation. The contractor shall allow for the setting out and installation around all obstructions. Additional costs incurred by the contractor due to the lack of coordination will not be accepted.
- Connections to all equipment to be made by the contractor.
- Any discrepancies between this drawing and on site conditions must be reported to Renaissance Engineering LTD. immediately. Any changes from this design drawing must be agreed with the Engineer in writing. A failure to gain the approval could lead to difficulty in approving payment for the variation(s).
- Installation / Construction / As-Built Drawings to be prepared by the Mechanical/Electrical Contractor with reference to the latest Architects and Structural Engineers construction issue drawings and fire certificate drawings.
- All Electrical works to comply with the National Rules for Electrical Installations, 5th Edition IS10101:2020.
- All Mechanical and Electrical works to comply with the current Building Regulations.
- All works to comply with the National Code of Practice for Customer Interface 5th Edition 2021.

- Legend**
- ESB 125mm Duct (@600 BFGL)
 - - - ESB 50mm Duct (@600 BFGL) From Mini-Pillar to Dwelling
 - x ESB Mini Pillar (EMP) (1000x1300x600d)
 - EIR 100mm Duct (@400 BFGL)
 - - - EIR 32-50mm Duct (@400 BFGL) From Chamber to Dwelling
 - x EIR Chamber (EC) JB4 - (910x440x800d)
 - 110mm Virgin Media Duct
 - - - Feeder Cable (18/14mm Microduct)
 - x EIR Chamber (EC) JB4 - (910x440x800d)
 - Street Lighting 100mm (@600 BFGL)
 - x EIR Chamber (EC) JB4 - (910x440x800d)
- A**
E
E Ansell Sorrento IP65 LED BULKHEAD WITH LOUURED EYELID COVERS - 4000K

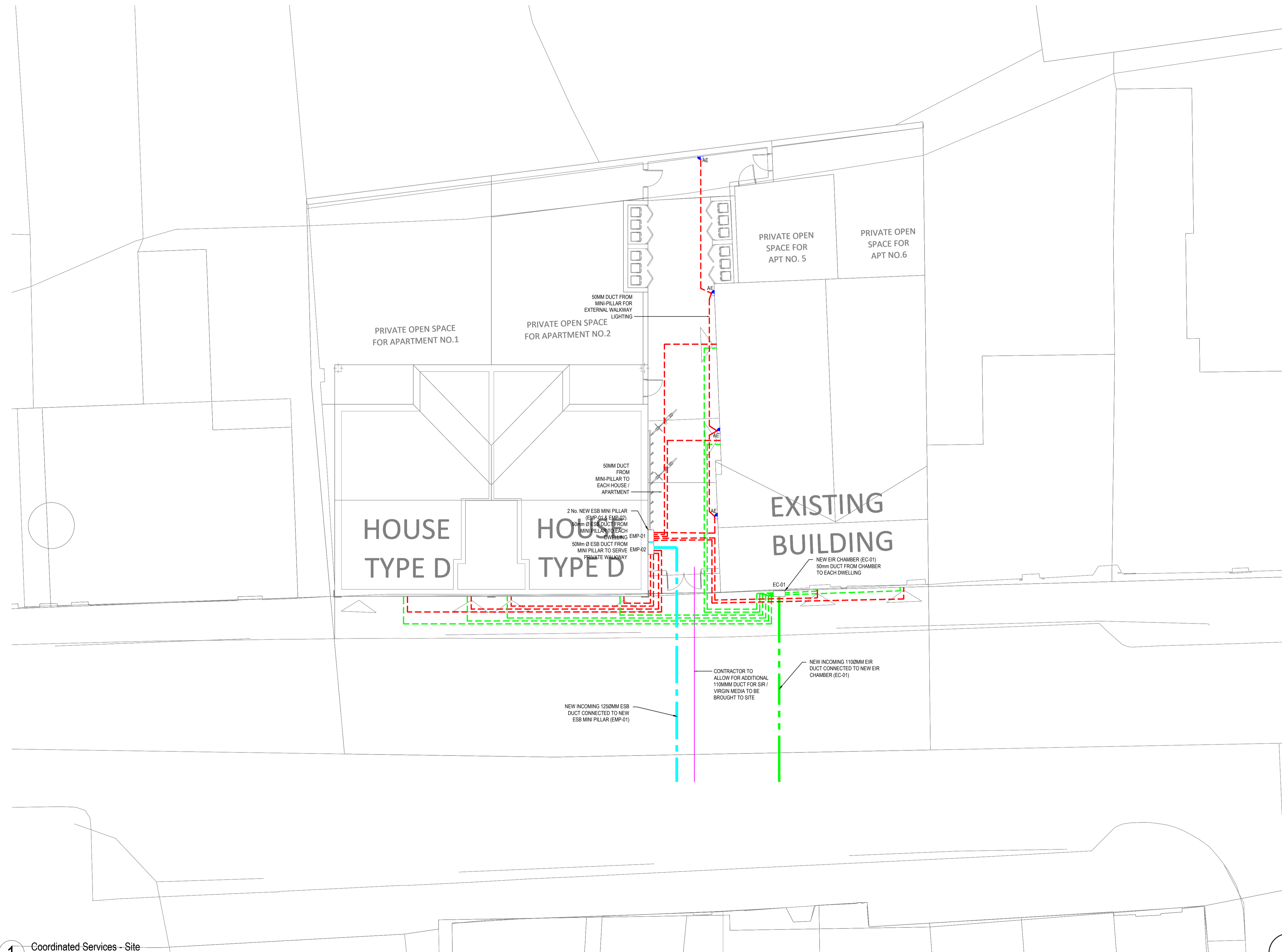

1 Coordinated Services - Site
1:100

P	09.06.23	Issued for Planning	SMcD	SM
Rev.	Date	Revision Description	Drm.	CHKd.

RE Renaissance Engineering
 Address: 2nd Floor, 67-70 Meath Street, Dublin 8, D08 YCK4, Ireland
 Telephone: +353 (0)1 675 0850
 Email: info@reng.ie
 Web: renaissanceengineering.ie

Status Code: -----

Client: **Cavan Co. Co.**

Architect: **Wynne Gormley Gilenan**

Job Title: **Housing Units, Kinalleck - Co. Cavan Main Street Development**

Drawing Title: **Coordinated Services Site**

Scale: 1:100	@A1	Drawing No.: 22215-REN-MS-SS-DR-ME-0001	Revision: P
Approved By:		CAD Filename: 22215-REN-MS-SS-DR-ME-0001.dwg	