

1 Site Layout 1:250

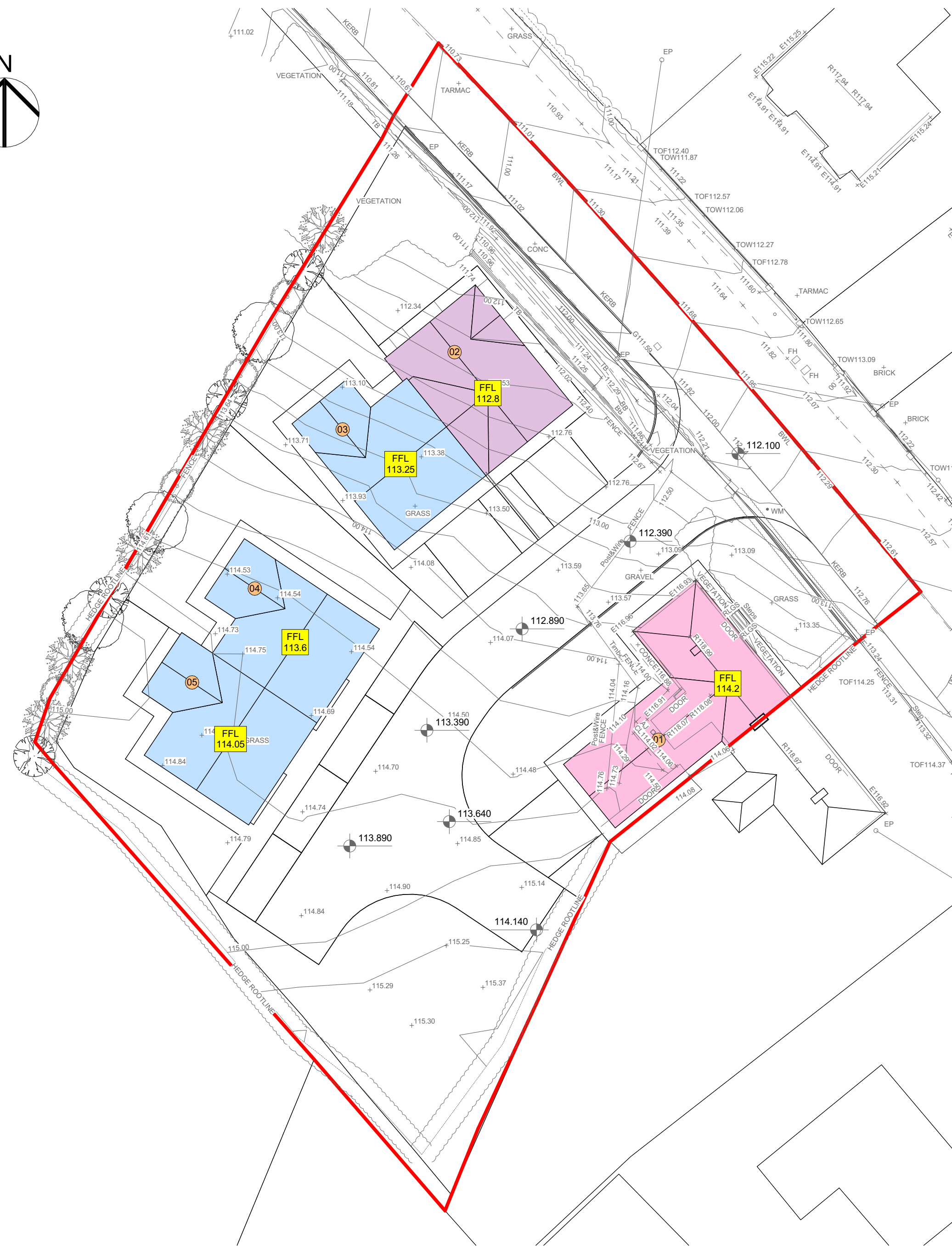
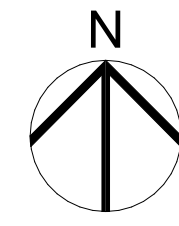

2 Site Survey 1:250

	Existing Access Road
	Existing Pedestrian Path Along Access Road
	Parking Space
	Footpath
	Private Open Space
	Public Open Space
	Site Boundary Area: 0.26ha / 0.64 acre

	House Type 'A' Bungalow 2 Bed / 3 Person 1 Units
	House Type 'B' Bungalow 2 Bed / 3 Person 3 Units
	House Type 'C' Existing & Extension Bungalow Semi Detached 3 Bed / 5 Person (UD) 1 Unit

Total: 5 Units

Plot Schedule	
Plot No	Area
01	170.3
02	107.1
03	52.7
04	63.4
05	53.0



Wynne Gormley Architects & Surveyors Ltd.

© WGG ARCHITECTS & SURVEYORS LTD
COPYRIGHT RESERVED

JOB DETAILS
Proposed Housing Development
@ 157 Barrack Road, Kinnaleck, Co. Cavan,
for Cavan Co. Council

Scale: @ A1 As indicated	Drawn no: PL22-075-200	Amend.
Date: 17/10/2023	Description: Site Layout & Site Survey	
Drawn by: J Mrowiec	Checked by: E Gilsean	

21, Church View, Cavan
T +353 49 43 61096
F +353 49 43 62907
E info@wggarchitects.ie
W www.wggarchitects.ie

